

A4556AA HYDRO PURGING KIT FOR MARKWIK MIXERS QUICK REFERENCE USER GUIDE

*Armitage
Shanks*

1. IMPORTANT CLEAN PIPES USING THIS PURGING KIT BEFORE OPERATING MIXER.

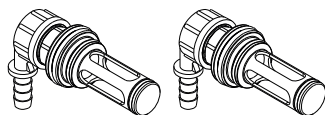

A4556AA Purging Kit. Designed for flushing out debris from new pipe-work after installation. (Ensure 2 o-rings are fitted to each chromed part.)

2. For use with Markwik Thermostatic Mixers:

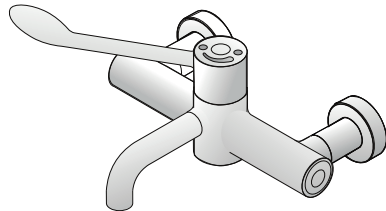

Note: for illustration purposes, Markwik panel mount lever operated product is shown.

3. IMPORTANT: Ensure both HOT & COLD water supplies have been isolated. This can be done using isolating valves fitted behind the shrouds/shields of the mixer. Refer to appropriate section of the mixer installation booklet. (Note: Markwik deck mount isolation is below basin).

4. Carefully prise out chrome button from end of mixer. COLD side of mixer.

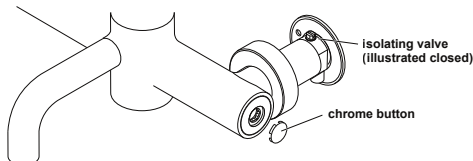

5. Use 10mm Allen Key to unscrew "end cap" & withdraw complete "maintenance carrier" assembly from maintenance port. (Expect some water trapped inside mixer to escape.)

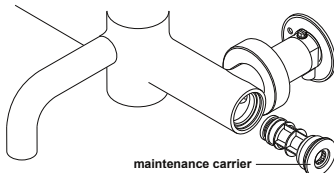

6. Fit one purging tool directly into the maintenance port. Hand tighten to shoulder or use 24mm open end spanner.

DO NOT OVER TIGHTEN. Screw plastic elbow assembly provided onto purge tool.

7. Push fit a suitable hose onto serrated portion of elbow. Repeat procedure from 4. & fit the second purging tool to HOT side. Elbows/hoses should be directed into the basin or an appropriate vessel.

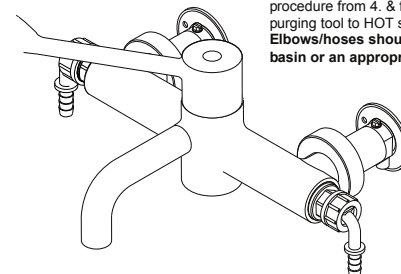

Alternative to plastic elbows: Hose-loc accessories can be connected to the purge tool, or suitable flexible hose with G3/4" (3/4" BSP) connection.

8. Open both isolating valves, allowing both HOT & COLD water to flow from the mixer through the purging kit and discharge through hoses into basin or vessel. Allow water to run for a few minutes, until no debris is visible in discharged water. Avoid contact with hot water.

9. Close isolating valves. Remove purging kit using reverse of fitting procedure. Check that the mesh filters/strainers of the maintenance carrier are clean before re-fitting. After refitting maintenance carrier, open isolating valves and check for leaks.

10. Continue with Operating & Commissioning procedure specified in mixer installation booklet.



Armitage Shanks pursues a policy of continuing improvement in design and performance of its products.

This right is therefore reserved to vary specification without notice.

Armitage Shanks is a division of Ideal Standard (UK) Ltd

AFTER SALES NON RESIDENTIAL HELPLINE

0870 122 8822

AFTER SALES NON RESIDENTIAL FAX

0870 122 8282

E-MAIL

aftersalesnonresidential@idealstandard.com

Ideal Standard International NV
Corporate Village - Gent Building
Da Vincilaan 2
1935 Zaventem
Belgium

www.idealstandardinternational.com

0116 / A 866 631
Made in Germany

*Armitage
Shanks*

A4556AA HYDRO PURGING KIT FOR MARKWIK MIXERS QUICK REFERENCE USER GUIDE

*Armitage
Shanks*

1. IMPORTANT CLEAN PIPES USING THIS PURGING KIT BEFORE OPERATING MIXER.

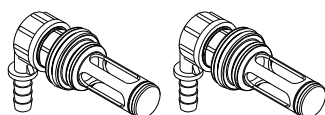

A4556AA Purging Kit. Designed for flushing out debris from new pipe-work after installation. (Ensure 2 o-rings are fitted to each chromed part.)

2. For use with Markwik Thermostatic Mixers:

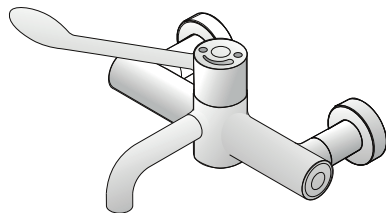

Note: for illustration purposes, Markwik panel mount lever operated product is shown.

3. IMPORTANT: Ensure both HOT & COLD water supplies have been isolated. This can be done using isolating valves fitted behind the shrouds/shields of the mixer. Refer to appropriate section of the mixer installation booklet. (Note: Markwik deck mount isolation is below basin).

4. Carefully prise out chrome button from end of mixer. COLD side of mixer.

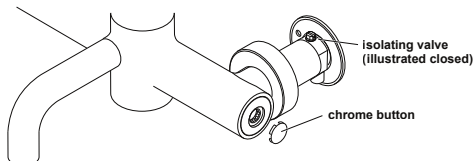

5. Use 10mm Allen Key to unscrew "end cap" & withdraw complete "maintenance carrier" assembly from maintenance port. (Expect some water trapped inside mixer to escape.)

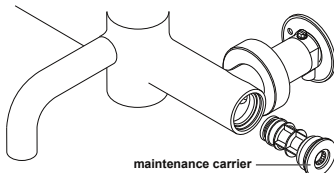

6. Fit one purging tool directly into the maintenance port. Hand tighten to shoulder or use 24mm open end spanner.

DO NOT OVER TIGHTEN. Screw plastic elbow assembly provided onto purge tool.

7. Push fit a suitable hose onto serrated portion of elbow. Repeat procedure from 4. & fit the second purging tool to HOT side. Elbows/hoses should be directed into the basin or an appropriate vessel.

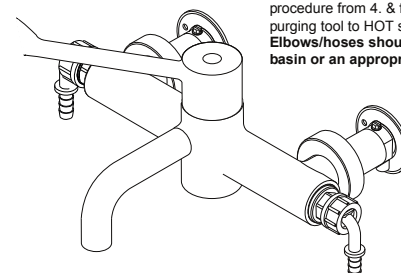

Alternative to plastic elbows: Hose-loc accessories can be connected to the purge tool, or suitable flexible hose with G3/4" (3/4" BSP) connection.

8. Open both isolating valves, allowing both HOT & COLD water to flow from the mixer through the purging kit and discharge through hoses into basin or vessel. Allow water to run for a few minutes, until no debris is visible in discharged water. Avoid contact with hot water.

9. Close isolating valves. Remove purging kit using reverse of fitting procedure. Check that the mesh filters/strainers of the maintenance carrier are clean before re-fitting. After refitting maintenance carrier, open isolating valves and check for leaks.

10. Continue with Operating & Commissioning procedure specified in mixer installation booklet.



Armitage Shanks pursues a policy of continuing improvement in design and performance of its products.

This right is therefore reserved to vary specification without notice.

Armitage Shanks is a division of Ideal Standard (UK) Ltd

AFTER SALES NON RESIDENTIAL HELPLINE

0870 122 8822

AFTER SALES NON RESIDENTIAL FAX

0870 122 8282

E-MAIL

aftersalesnonresidential@idealstandard.com

Ideal Standard International NV
Corporate Village - Gent Building
Da Vincilaan 2
1935 Zaventem
Belgium

www.idealstandardinternational.com

0116 / A 866 631
Made in Germany

*Armitage
Shanks*